

Ersatzteilliste-Explosionszeichnung

Glastürtiefkühlschrank MF 180

[Artikel-Nr.: 4778511801]

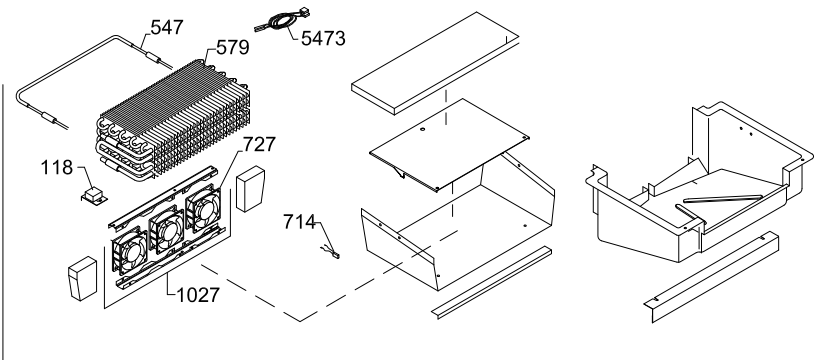

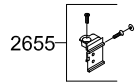
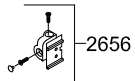
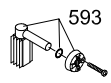

0586 A

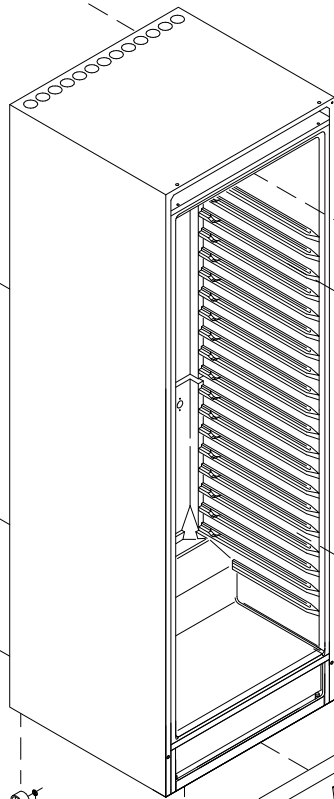
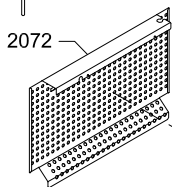
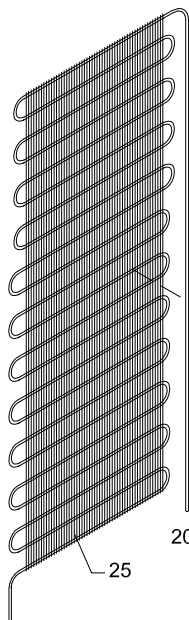

705

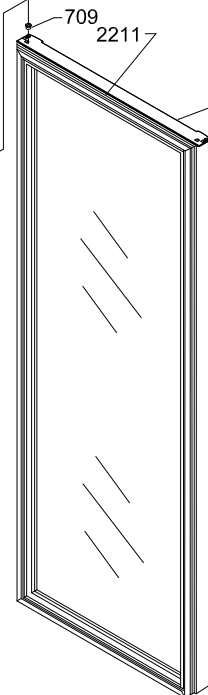

2201

2600

3134

592

709

2211



5471

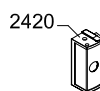
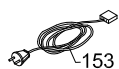
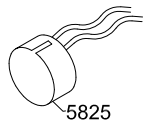
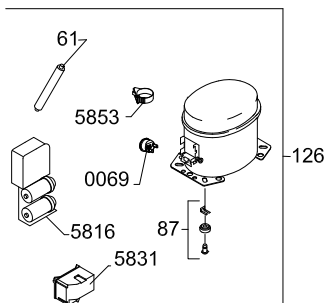

2

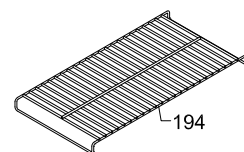
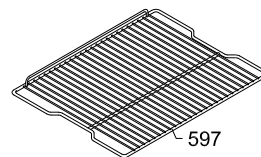
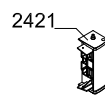
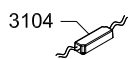
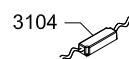

199

Pos.	Itemnumber	Itemname	
2201	0-0280309850	Tür, komplett, glas	
0592	0-4238081	Leitkanal	
0704	0-4838088	Angelzapfen	
0199	0-4838236	Schlüssel, Satz - 2 Stück	
0087	0-6038175	Fussplattenzubehör,, komplett	
2021	0-6238146	Kondensator	
0061	0-6538001	Trockner,	
0597	0-6938030	Drahtabstellplatte	
0194	0-6938031	Drahtabstellplatte	
0547	0-7038140	Heizelement	
0579	0-8050204	Verdampfer	
2600	0-A90135301	Handgriff	
2655	0-A910112	Anschlagflèche für Scharnier, rechts, komplett	
2656	0-A910133	Anschlagflèche für Scharnier, links, komplett	
2430	0-A9151272	Schloss komplett	
XXXX	1006499	Wire diagram	
0705	1510062	Feder	
2423	1510175	Fußschraube	
2072	2042238-03	Motordeckplatte	
0702	2042297-03	Scharnier, rechts	
0709	3010373-03	Buchse	
2211	3020673-03	Dichtungsleiste	
0025	6010463	Kondensator	
0069	6520415	Überlastschutz	
5831	6520416	Deckel	
3134	7010228	LED light, tür	
0118	7020227	Bimetallthermostat - Defrost	
5473	7020370	NTC-Sensor Kit	
5825	7020375	Transformator	
3104	7020376	Transformator 12V	
3104	7020377	Transformator 24V	
0714	7020992	Thermorelais	
0727	7030300	Ventilator	
5790	7060146	EMI filter	
1027	7090166	Ventilator, komplett - 3 im Reihe	
5712	7095160	Elektronische Einheit ERC 112D	
5816	7095162	CSR elektrische box für NEK2160U	
5471	7095164	Bodenpaneel, Fussleiste - komplett	
0586A	7095174	Verdampferkasten, komplett	
6553	7535442	Netzanschlussleitung	
0126	8-036510287309	Kompressor -NEK2160U Embraco 230V Embraco	
2420	A102530217	"L" Scharnier + Abdeckung	
2421	A102530219	"R" Scharnier + Abdeckung + tap	
0067	A5238026	Rad , komplett	

Finanzen/Service

28307 Bremen
Thalenhorststraße 15
Tel.+49 421 48557-0
Fax+49 421 488650
bremen@nordcap.de

Vertrieb Ost

12681 Berlin
Wolfener Straße 32/34, Haus K
Tel.+49 30 936684-0
Fax+49 30 936684-44
berlin@nordcap.de

Vertrieb West

40699 Erkrath
Max-Planck-Straße 30
Tel.+49 211 540054-0
Fax+49 211 540054-54
erkrath@nordcap.de

Vertrieb Nord

21079 Hamburg
Großmoorbogen 5
Tel.+49 40 766183-0
Fax+49 40 770799
hamburg@nordcap.de

Vertrieb Süd

55218 Ingelheim
Hermann-Bopp-Straße 4
Tel.+49 6132 7101-0
Fax+49 6132 7101-20
ingelheim@nordcap.de

